



# Drivers Meeting for Fuel, Tilt, Noise, Brake, and Practice

May 18<sup>th</sup>, 2023

Michigan International Speedway

# General Announcements

- Hot areas appropriate behavior and dress
  - Long Pants, closed toe shoes, no running
- Number of team members allowed in hot area
  - 4 with dynamic pass (including driver)
- How to identify event Captains
  - Pink Vest
- Weather
  - track condition and tire requirements
  - emergency locations
  - announcements, tunnels





# Event Layout 2023

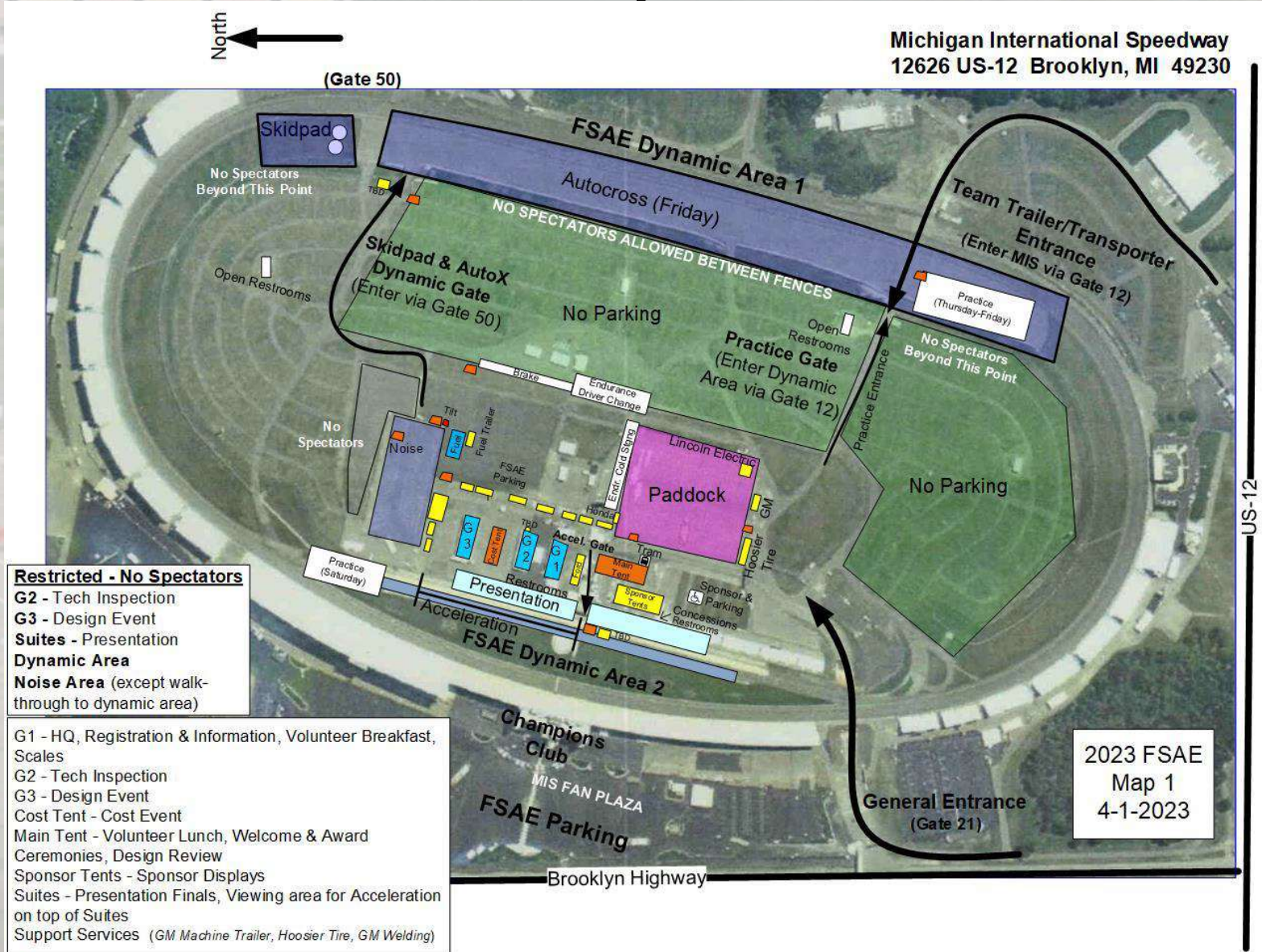



# SCCA/SAFETY



Safety Steward: Cindy Wisner

Co - Steward: Ed Arthur

Co - Steward: Alex Della Torre (RE)

**FORMULA  
SAE**®

# FUEL STATION

Thursday

9:00am – 5:00pm

Friday

8:00am – 5:00pm

Saturday

7:30am – End of Endurance

Captain: Herb Seubert

Co - Captain: Rob Egenolf

Co – Captain: Janice Hueske

Fuel Station Committee Man: Mike Thodoroff

Fuel Economy Event Captain: Alba Colon

Co - Captain: Mark Scott

**FORMULA  
SAE®**



# 2023 FUEL STATION

## Follow specific safety guidelines while in the fueling area:

- No vehicles will receive fuel before passing Tech
- Teams must bring the Tech sheet for approval. After passing Tilt, that is no longer required.
- For vehicles en route to Tilt – after initial fill, teams will be requested to tip their car in the Fuel Station. The vehicle can also be shaken. This is to free up any trapped air. After passing Tilt, manipulating the vehicle will not be allowed until the Fuel Economy process.
- All engines and electronics must be shut down and turned off; cars are to be pushed to and from fueling.
- Only the vehicle push crew and the driver are allowed to enter the fueling station and all must have their dynamic passes to enter.
- Only the driver, fully dressed in all safety gear, with vehicle fire extinguisher in hand, is permitted in the area as fuel is dispensed.
- A Permanent line mark must be used to indicate the “full” level.
- **NO TAPE or ZIP TIES**
- Tank will be filled accurately to the fill line for Tilt, Endurance, and Fuel Economy events only. The tipping process used for Tilt will also be used for the Fuel Economy process.

2023 FSAE Fuel Station  
Overall Area, Endurance Sat  
11/9/22 Map 7

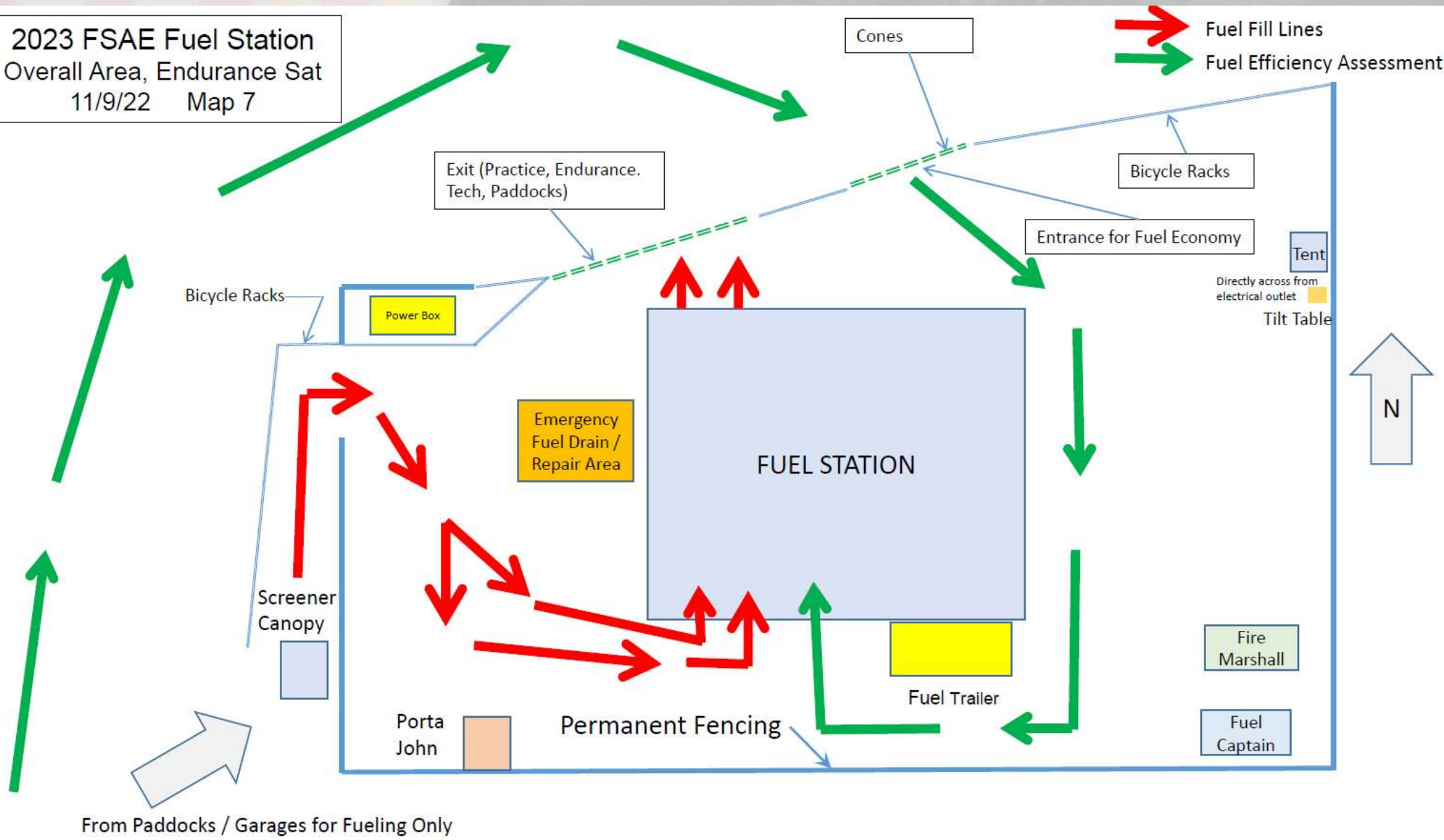



# TILT TABLE

Thursday

9:30am – 5:00PM

Friday

8:00am – 5:30PM

Captain:

Alba Colon

Co - Captain:

Mark Scott

Asst. Co – Captain:

Herb Seubert

**FORMULA  
SAE®**



# TILT TABLE PROCESS

- The tallest driver aboard, fully suited, helmet buckled, gloves and all safety restraints secured.
- Engine off, push car on and off table. Care must be taken to avoid damage to the vehicle when pushed on and off the tilt table.
- Fuel fill side of vehicle is to be placed against the guard of the tilt table.
- Vehicle will be raised to 45 degrees, and checked for leaks
- Then the vehicle will be raised to 60 degrees to assure tire contact with table.
- Car will be asked to exit and if passed 2<sup>nd</sup> sticker will be applied prior to leaving area.

# NOISE TEST

Thursday  
10:00am – 5:00PM

Friday  
8:00am – 5:30PM

Captain: Greg McConville

**FORMULA  
SAE®**



# NOISE TEST PROCESS

- Vehicles may be warmed up in the warming bays with a fully suited and belted driver.
- It is the teams' responsibility to show the RPM via tachometer, computer or display. NO LIGHTS!
- When directed, the team will push the vehicle into the test station with the car in neutral.
- The team will hand their tech sheet (with engine information filled in) to the noise official who will confirm the designated test speed.
- Test speed is approximately  $\frac{3}{4}$  of the maximum engine speed as calculated by the SAE approved formula.
- The sound level meter will be positioned 0.5m from, and level with, the exhaust outlet at an angle of 45 degrees from the outlet and be un-obstructed.
- In the case of dual exhausts, both exhausts will be tested with the loudest one being the basis for judgment.

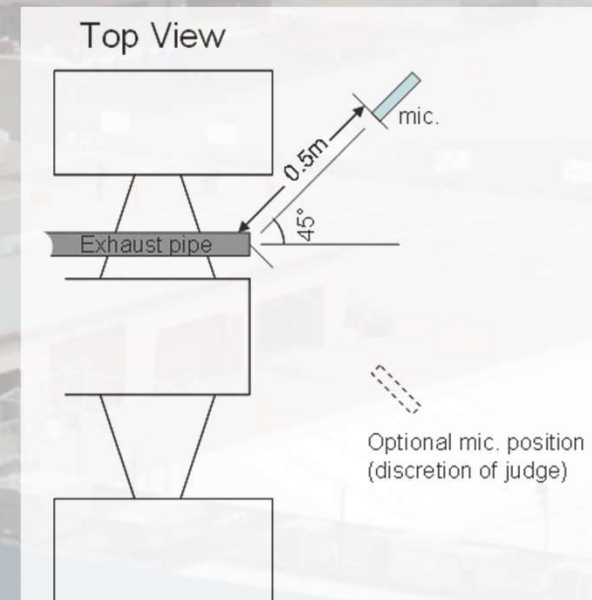
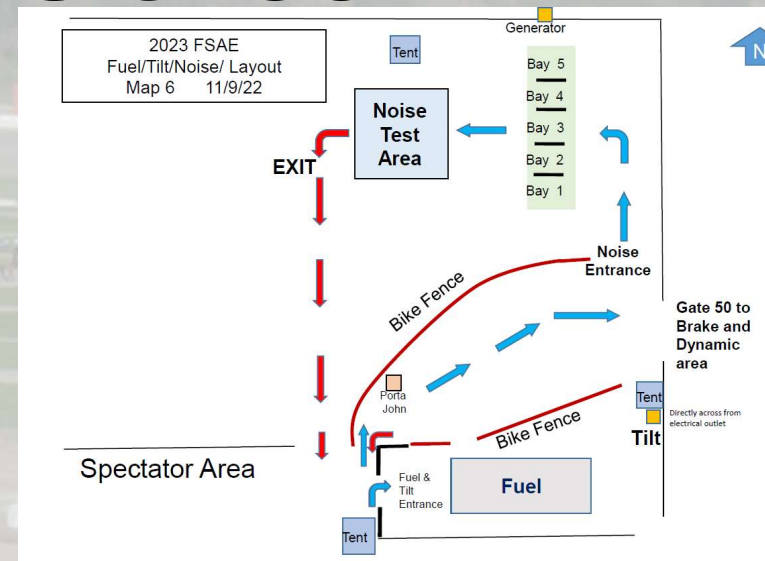

# NOISE TEST PROCESS

- Idle sound limit is 103 dBC. If team passes idle, driver will be asked to rev the engine to the target test speed.
  - You must complete idle test before doing run up test
- Maximum sound level shall not exceed 110dBC (margin of error +/- .5dBC).
- Official will check the kill switch with the engine at test speed.
- Meters are calibrated and will be checked and verified on-site on a regular basis!
- The reading of the meter by the official is final and not open for debate.
- Once Passed a 3<sup>rd</sup> tech sticker will be applied.



# **BRAKE TEST AND OVER TRAVEL SWITCH TEST**

**Thursday  
10:30am – 5:00pm**

**Friday  
8:00am – 5:30pm Sharp!**

**Captain: Alba Colon**

**Co-Captain: Mark Scott**

**FORMULA  
SAE®**

# Brake Test Procedure

- Driver must be wearing complete and proper safety equipment.
- Tires will be checked by screener prior to test, 20 PSI Max!
- The driver will be instructed to the start line.
- After starter checks the workers the driver directed to start the run.
- With-in the brake box formed by water barriers, the vehicle must lock all 4 wheels and come to a complete stop with the engine running.
- Driver will then proceed thru course and follow directions from flaggers.
- If vehicle needs to be tested again, you will be instructed to proceed back to start line and Stop, then re-run the test.
- If the vehicle passes the driver will be instructed to exit and turn engine OFF, the FINAL sticker will be given to team and must be applied prior to leaving the area.
- The Tech sheet remains with the Brake Captain as completion notification.



# Brake Layout – Infield Location

N →



2023 FSAE  
Brake Layout  
Map 8 11/16/2022

# Practice Area

Thursday

11:00am – 5:00pm

Friday

8:00am – 5:30pm

Saturday

7:30am – 3:00pm ish (Turn 4)

- Captain: Gary Godula
- Co-Captain: David Dashwood

**FORMULA  
SAE®**



# Safety guidelines for the Practice Tracks:

- Only one car at a time in the Practice Track area.
- The next car will not be permitted to enter the area until the last one has completed its exit.
- Three (3) volunteers (preferably four (4)) will be on hand to manage the operation of the Practice Track.
- Never place yourself in the line of travel of any car. Stay well away from the “hot” areas, always at a safe distance behind the barriers.
- Have fire extinguishers handy.
- Use brooms and oil-dry as needed to keep the Practice Track clean and dry.
- Any vehicle damage or contact must be reported to the area (station) manager(s). Additionally, remove the 1st tech sticker and report car number to tech tent so car can be re-evaluated after repair.
- Do not permit spectators to sit or lean on the barriers surrounding the practice tracks.



**Thursday/Friday Only**

Gate 12

2023 FSAE  
Practice Layout  
(Thursday/Friday)  
Map 9 10/10/2022

-  Push Path
-  Bike Fence
-  Water Barrier
-  Cones

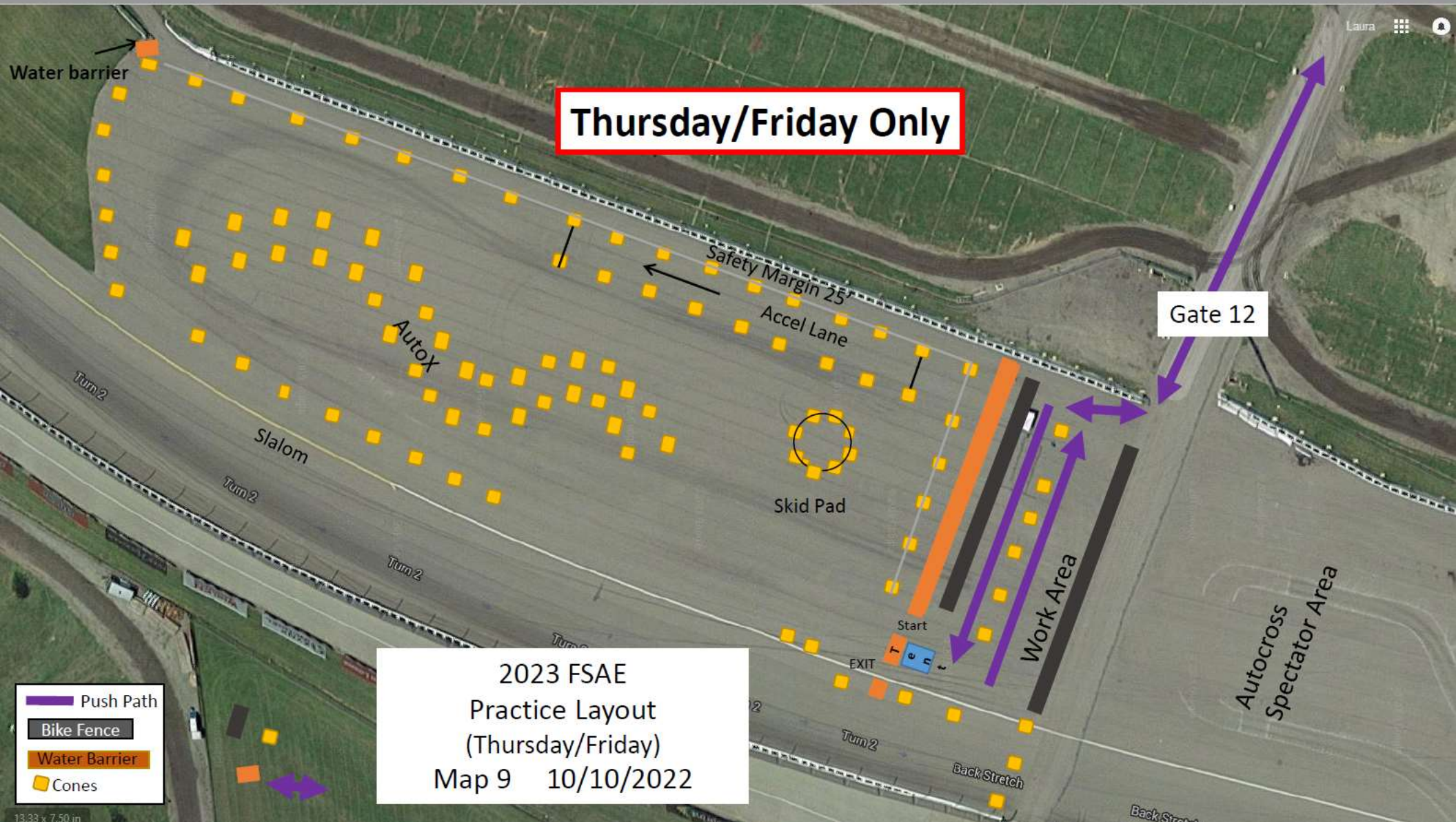



**Saturday Only**

